

# SZAFKA

## WIKI 180

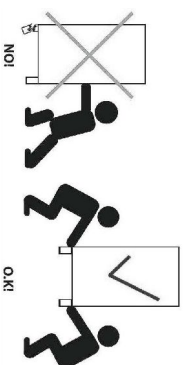
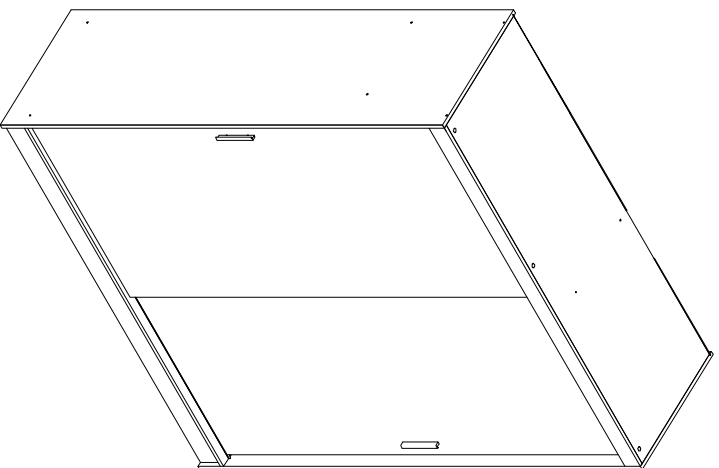

24.06.2015

- (D) Montageanleitung
- (FR) Notice de montage
- (NL) Handleiding voor de montage
- (CZ) Montážní návod
- (HU) Szerelési útmutató
- (TR) Montaj talimatı
- (GB) Assembly Instructions
- (IT) Istruzioni di montaggio
- (PL) Instrukcja montażu
- (SK) Návod na montáž
- (RO) Instrucțiunile de montaj
- (RU) Инструкции по монтажу

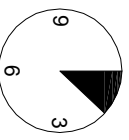
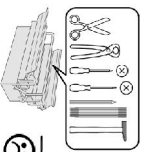

2-2,5

1

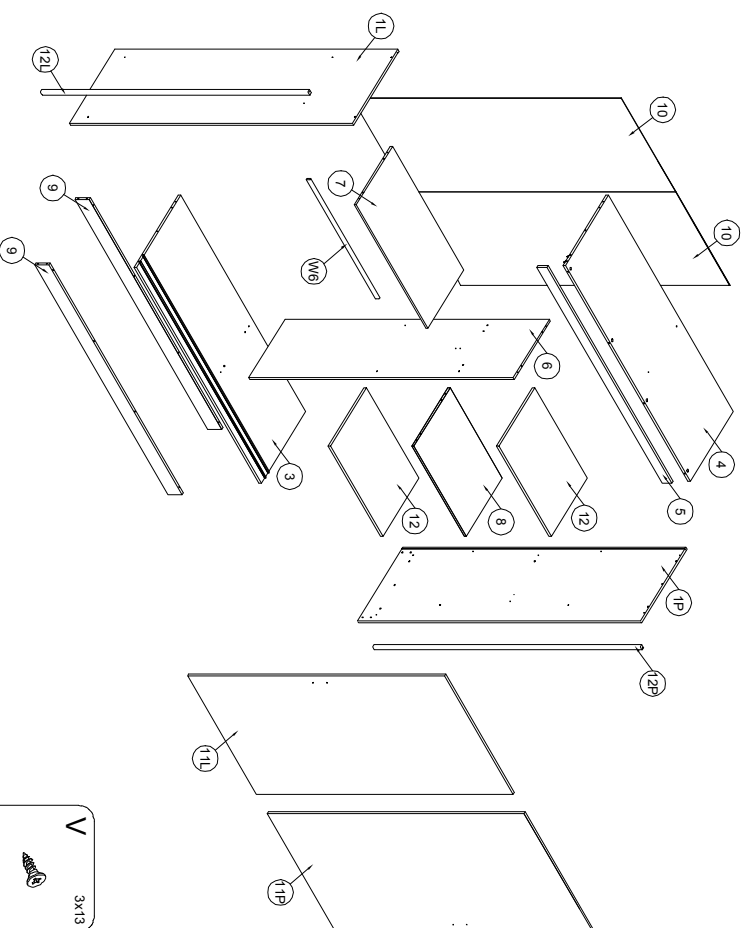

SP X12 W6 L-586mm	H X16 ZB	W X2 X	YA X4 ZC	L5 X1 DA	D X4 N	DB L-1850mm X2 YD	LM X10 WB	V X20 3x13
A X40 8x32	T X2 T	ND X16 3.5x16	B X4 B	GLUE X2	C X4 C	Z X4 Z	ZG X1 ZG	

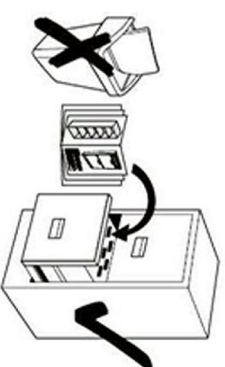
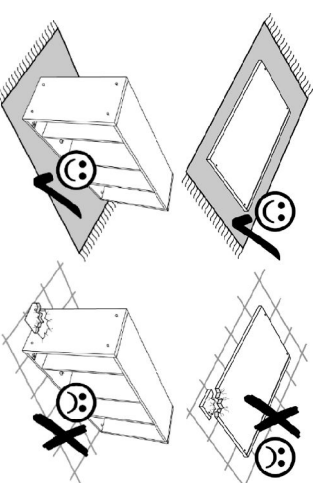

2

- A 8x32 x12
- V 3x13 x20

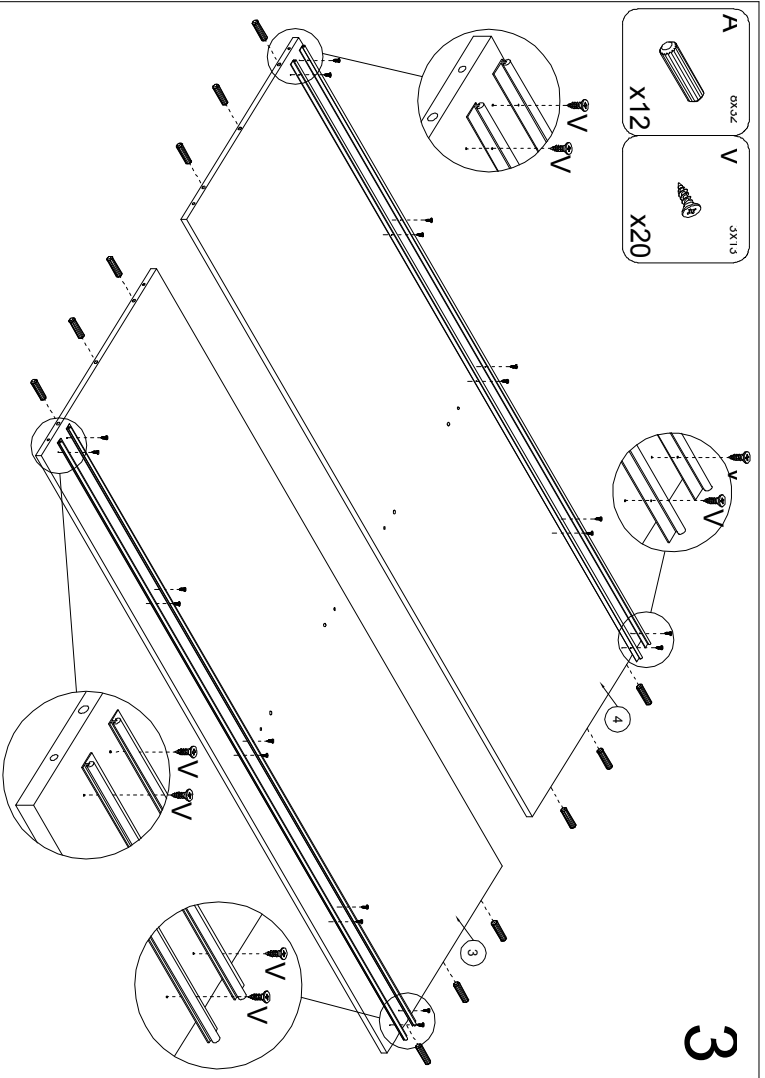

3

- A 8x32 x4
- T 3x2 x2
- ND 3.5x16 x4

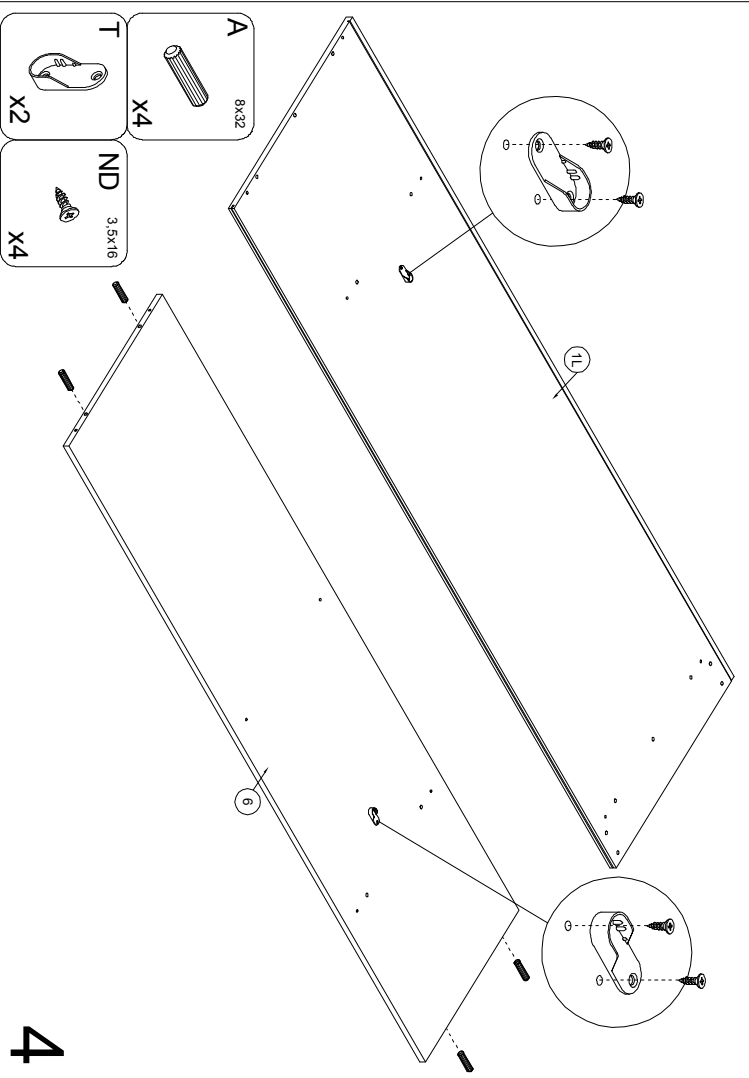

4

- A 8x32 x24
- B 3x4 x4
- GLUE x1

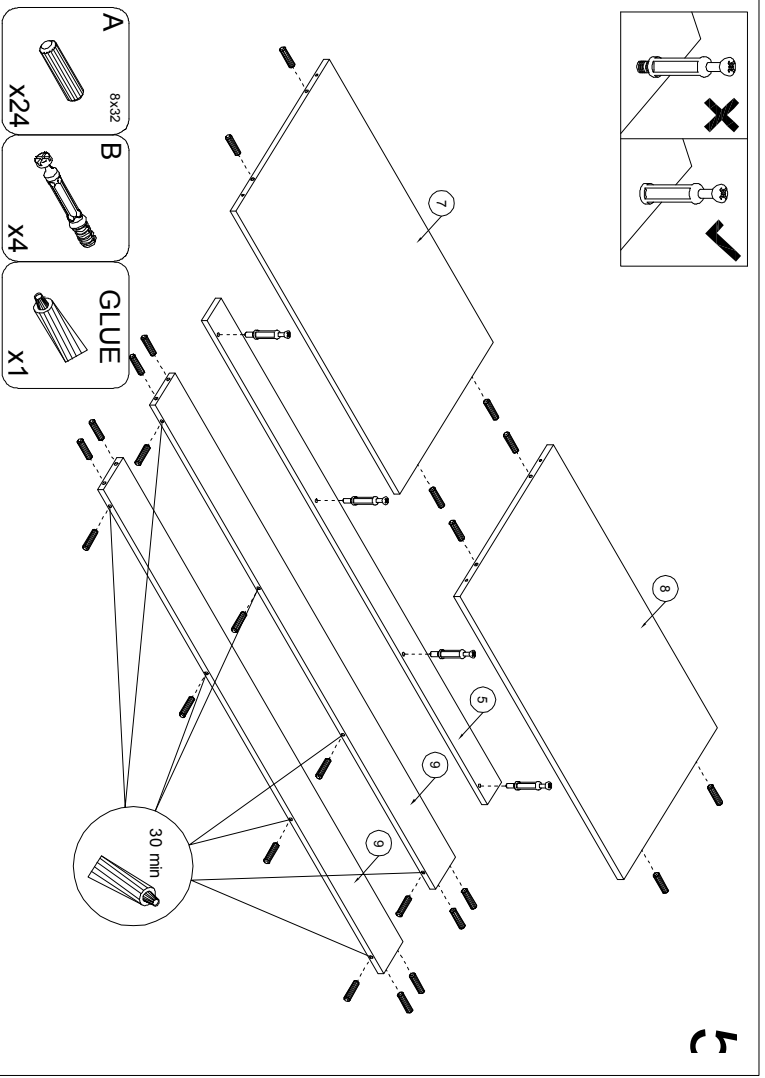

5

- 1
- 2

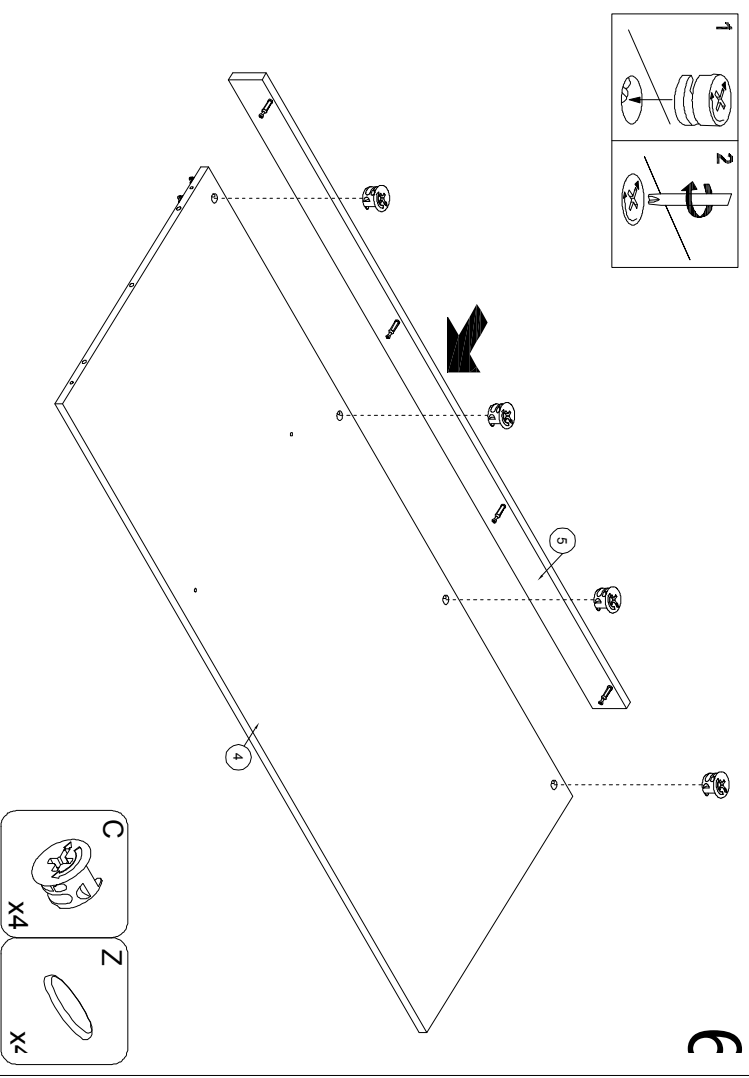

6

- C 3x4 x4
- Z 3x4 x4

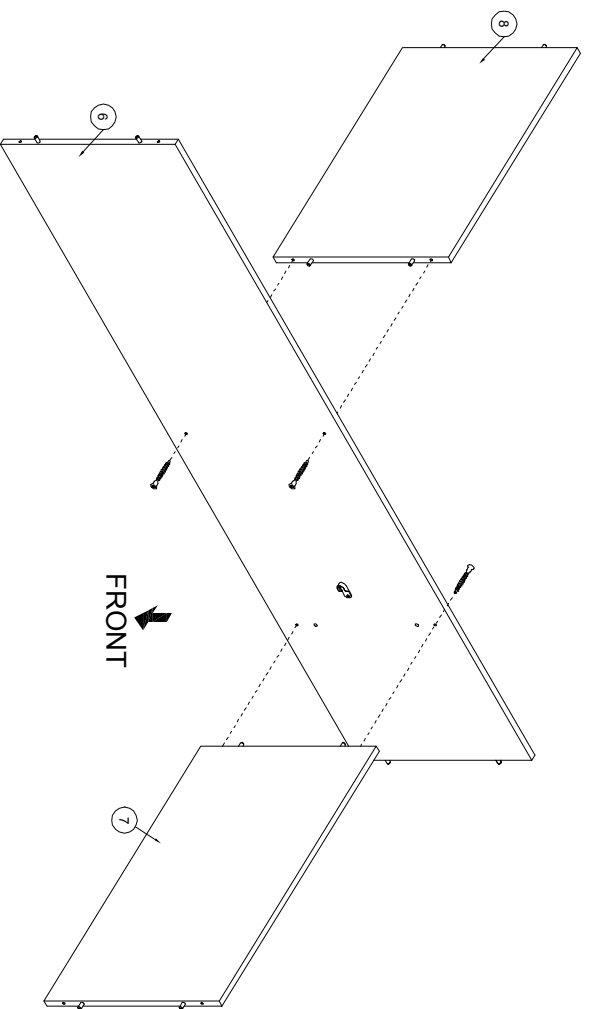

- YD 7x50 X4
- WB X1
- ZG X4

7

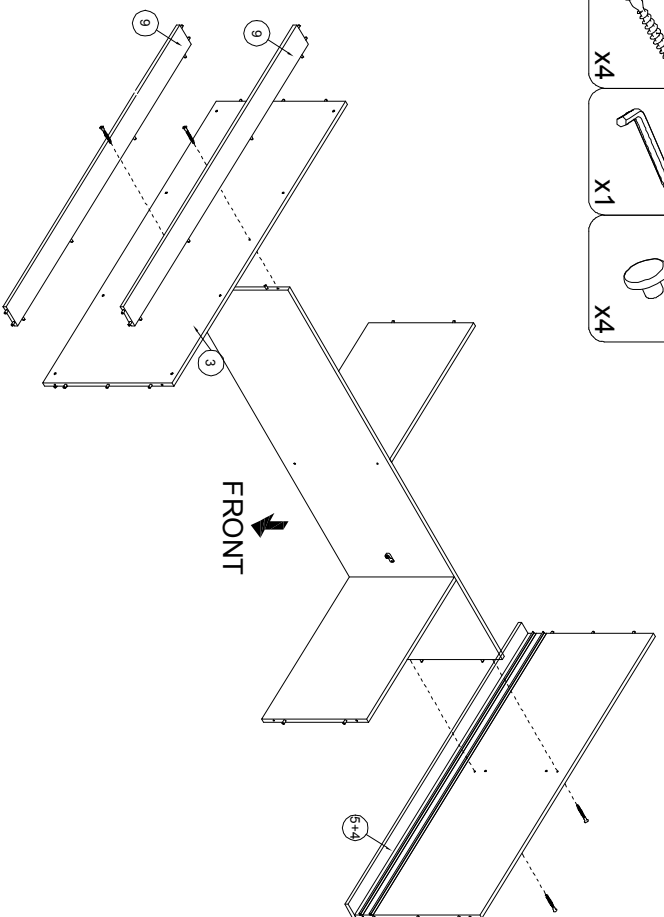

- YD 7x50 X4
- WB X1
- ZG X4

8

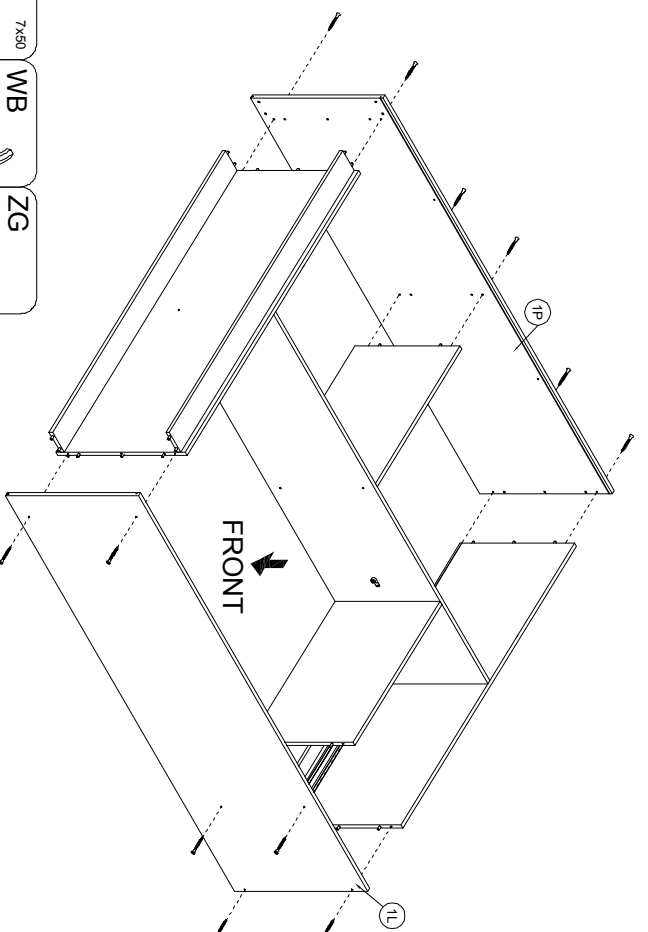

- YD 7x50 X12
- WB X1
- ZG X12

9

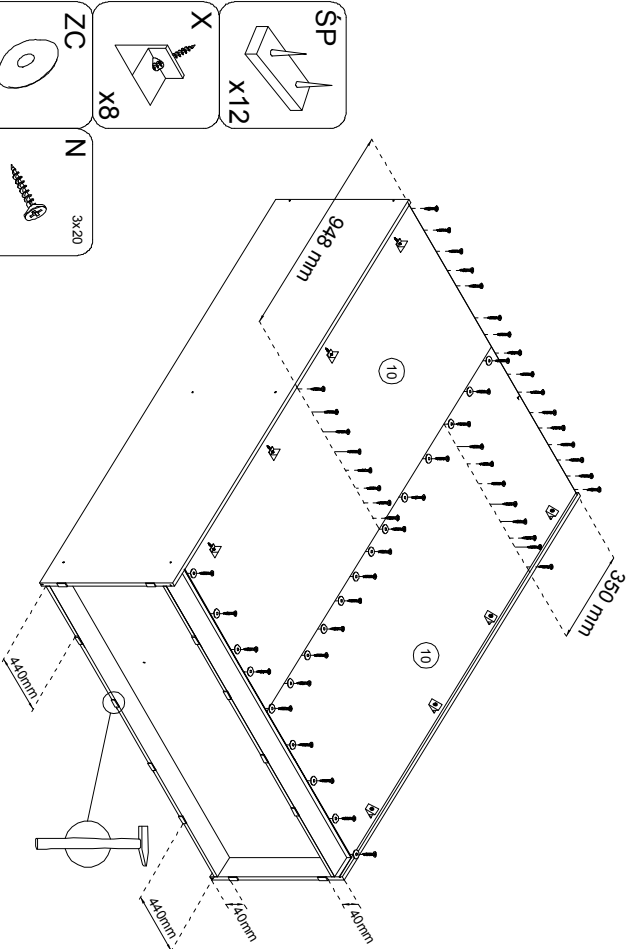

- SP X12
- X X8
- ZC X23
- N 3x20 X53

10

